

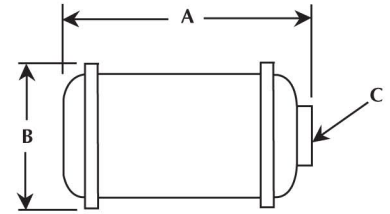

ACCESSORIES

INLET FILTERS

These filters are designed to protect the Fuji Ring Compressor by filtering the inlet air when the blower is being used for pressure applications. The filter has a perforated metal outer cover and an inner liner wrapped with a fine (.009) mesh screen. The filter is rated for 200 micron filtration.



INLET FILTER COVERS

These covers are designed to fit over the inlet filter in order to provide better filter protection. They are made of 100% polyester fibers, are approximately 3/4" thick, and are rated 80% efficient at 25 microns.

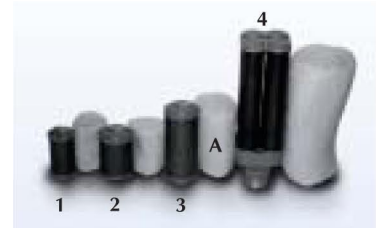

(1) F-123 & C-123, (2) F-45 & C-45, (3) F-67 & C-67 (4) F-89 & C-89

INLET FILTER					FILTER COVER
Filter Model	For Use With Blower Model:	A Dim. (in.)	B Dim. (in.)	C Dim. (in.)	Filter Cover Model:
F-123	VFC063-VFC300	7 3/8"	3 7/8"	1 1/4" FPT	C-123
F-45	VFC400-VFC504/500	8"	5 1/8"	1 1/2" FPT	C-45
F-67	VFC600-VFC704	14"	5 1/8"	2" FPT	C-67
F-89	VFC804-VFC904	23 1/2"	8 1/4"	3" MPT	C-89

INLET FILTERS / SILENCERS

The inlet filter / silencers are designed to protect the Fuji Ring Compressor by filtering the inlet air and quieting the blower when used for pressure applications. The filter has a pleated paper inner filter element rated at 10 microns. A metal outer cover is easily removable when servicing the unit.



REPLACEMENT ELEMENTS

These are replacement elements for the Inlet Filter / Silencers. They are pleated paper elements rated for 10 microns filtration.

(Other filter elements available upon request. For example: HEPA & others)

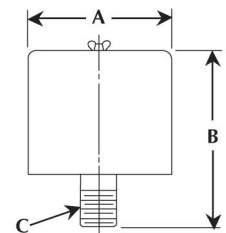

INLET/SILENCER FILTER					REPLACEMENT ELEMENT
Filter/Silencer Model	For Use With Blower Model:	A Dim. (in.)	B Dim. (in.)	C Dim. (in.)	Replacement Element Model:
FS-123	VFC063-VFC300	6"	6 1/2"	1 1/4" MPT	FS-123E
FS-45	VFC400-VFC504/500	10"	7 1/4"	1 1/2" MPT	FS-45E
FS-67	VFC600-VFC704	8 5/8"	20 3/8"	2" MPT	FS-67E
FS-89	VFC804-VFC904	12 3/4"	22 1/2"	3" MPT	FS-89E

ACCESSORIES

INLINE VACUUM FILTERS

These filters are designed to protect the Fuji Ring Compressor by filtering the inlet air when the blower is being used for vacuum applications. A metal housing with a removable cover, retained by clamps encloses a pleated paper filter element rated for 10 micron filtration.



REPLACEMENT ELEMENTS

These are replacement elements for the Inline Vacuum Filter. They are pleated paper elements rated for 10 microns filtration.

(Other filter elements available upon request. For example: Hepa, etc.)

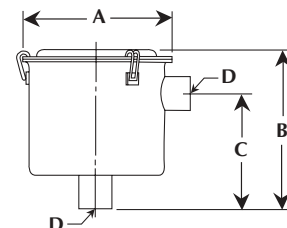

INLINE VACUUM FILTERS						REPLACEMENT ELEMENT
Filter Model	For Use With Blower Model:	A Dim. (in.)	B Dim. (in.)	C Dim. (in.)	D Dim. (in.)	Replacement Element Model:
IVF-01	VFC063-VFC100	5 7/8"	4 3/8"	2 5/8"	1 1/4" FPT	IVF-01E
IVF-23	VFC200-VFC300	7 5/16"	6 1/2"	4 1/2"	1 1/4" FPT	IVF-23E
IVF-45	VFC400-VFC500A/VFC504P	7 5/16"	6 1/2"	4 1/2"	1 1/2" FPT	IVF-45E
IVF-67	VFC600-VFC704	8 3/4"	10 1/4"	5 1/2"	2" FPT	IVF-67E
IVF-89	VFC804-VFC904	14"	27 1/8"	18 1/2"	3" MPT	IVF-89E

ACCESSORIES

INLINE FILTER / TRAPS

These Inline Filter Traps are 6" diameter plastic filters with a perforated metal basket and are available in either 12" or 24" lengths. They are used with the Fuji Ring Compressors through model VFC704A for trapping lint, string, paper, etc. 1 1/2" and 2" hose connections are available.

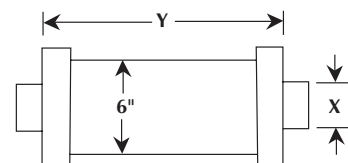

INLINE FILTER TRAPS		
Model No.	X Dim. (in.)	Y Dim. (in.)
TX1215	1 1/2"	12"
TX1220	2"	12"
TX2420	2"	24"



EXHAUST SILENCERS (MUFFLER)

Although the Fuji Ring Compressors are very quiet during operation, there are times when an additional exhaust silencer may be needed. These silencers allow quieter operation of the blowers in environments where noise levels are critical. The exhaust silencer reduces the noise level by approximately 5 dBA.

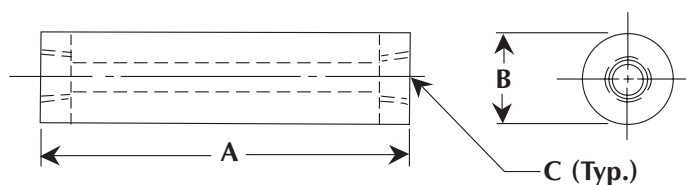

EXHAUST SILENCERS (MUFFLERS)				
Exhaust Silencer Model:	For Use With Blower Model:	A Dim. (in.)	B Dim. (in.)	C Dim. (in.)
VFY-021A	VFC063-VFC200	12"	2 1/2"	1" FPT
VFY-023A	VFC300	12"	2 1/2"	1 1/4" FPT
VFY-024A	VFC400-VFC500	12"	3"	1 1/2" FPT
VFY-026A	VFC600-VFC704	15 3/4"	3 1/2"	2" FPT
VFY-028A	VFC804	21"	4 1/2"	2 1/2" FPT
VFY-029A	VFC904	26"	5"	3" FPT

ACCESSORIES

INLET FILTERS / RECEIVERS

Certain applications require an inlet filter and a receiver to retain the dust or debris that is collected during operation. These filters include a fine (.009) mesh screen around which is wrapped a perforated metal outer cover. An additional outer cover made of 100% polyester fibers in a layer about 3/4" thick provides filtration rated 80% efficient at 25 microns. These filters are mounted inside of a receiver, available with either a 15 gallon capacity (18 ga. steel) and 1 1/2" hose connections, or a 30 gallon capacity (16 ga. Steel) and 1 1/2" or 2" hose connections. Hose not included.

Options include a fiberglass screen collection bag to facilitate material removal, and receiver support stand with blower mounting surface (pictured).

These filter / receivers are intended for use with medium weight, low volume materials, wood chips, saw dust, light metal chips, and dirt and dust, where a large filter area is not required.

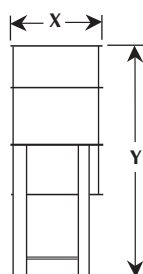

(A) Vacuum flow from receiver to blower; (B) Vacuum flow to receiver; (C) Filter

INLET FILTER/RECEIVERS			
Part No.	Size	X Dim. (in.)	Y Dim. (in.)
R15P1.5	15 Gallon w/ 1 1/2" inlet and outlet	15	26
R15PS1.5	15 Gallon w/ 1 1/2" inlet and outlet, including stand*	15	40
R15P2	15 Gallon w/ 2" inlet and outlet	15	26
R15PS2	15 Gallon w/ 2" inlet and outlet, including stand*	15	40
R30P1.5	30 Gallon w/ 1 1/2" inlet and outlet	19	30
R30PS1.5	30 Gallon w/ 1 1/2" inlet and outlet, including stand*	19	47
R30P2	30 Gallon w/ 2" inlet and outlet	19	30
R30PS2	30 Gallon w/ 2" inlet and outlet, including stand*	19	47

*Please specify blower model to be used, to ensure correct mounting hole pattern.

FIBERGLASS SCREEN COLLECTION BAG

Model No.	For Use With:
FB15FG	R15P/PS...
FB30FG	R30P/PS...

ACCESSORIES

HIGH VOLUME FILTER / RECEIVERS

Occasionally, an application requires a larger filtration area than the standard Fuji Inlet Filter/Receiver offers. These High Volume Filter/Receivers are constructed with an outer housing made of 16 ga. steel and have an inner liner made of perforated metal, which provides support for a Canton flannel canvas filter bag. An additional, inexpensive, disposable/reusable bag fits inside the flannel bag to provide an easy means to remove the collected material from the receiver. The inlet and outlet connections are for 2" (FR30) and 2 1/2" (FR55) hose.

NOTE: Swivel Elbow Inlet is optional.

The High Volume Filter/Receivers are designed for use with lightweight materials such as textile lint and dust. It may be used for powders, pellets, etc., but the volume of material collected would be limited due to the weight of the material in the bags. Not intended for use with wet product.



(A) Vacuum flow from receiver to blower; (B) Vacuum flow to receiver; (C) Canton flannel filter bag (1 extra with each model); (D) Disposable / Reusable filter (10 with each model).

HIGH VOLUME FILTER / RECEIVER		
Model No.	X Dim. (in.)	Y Dim. (in.)
FR-30	19"	30"
FR-55	23"	36"

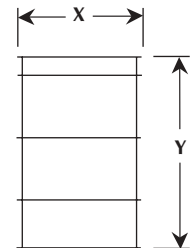

CANTON FLANNEL FILTER BAGS

Model No.	For Use With:
FR-30FB	FR-30
FR-55FB	FR-55

DISPOSABLE / REUSABLE FILTER BAGS

Model No.	For Use With:
FR-30DRB	FR-30FB
FR-55DRB	FR-55FB

ACCESSORIES

VACUUM AND PRESSURE RELIEF VALVES

Most Fuji Ring Compressors cannot be operated in a "dead-head" condition. These relief valves are designed to protect the blowers from overheating when operating dead-headed, either under vacuum or pressure. The valves are preset to provide the proper protection for the appropriate model, which is approximately 90% of the dead-head vacuum or pressure level, and is adjustable to a lower pressure or vacuum setting.

Factory setting at points other than standard can be made if specified on the order. Please allow two extra weeks for delivery. However there are limits for each individual relief valve.

VACUUM RELIEF VALVES			
Model No.	For Use With Blower Model:	Factory Setting ("H ₂ O")	Thread Size
VV3	VFC300	39	1 1/2" FPT
VV4	VFC400	42	1 1/2" FPT
VV5	VFC504/500	60	1 1/2" FPT
VV6	VFC600	86	2" FPT
VV7	VFC704	85	2" FPT
VV8	VFC804	100	2" FPT
VV9	VFC904	100	2 1/2" FPT

PRESSURE RELIEF VALVES			
Model No.	For Use With Blower Model:	Factory Setting ("H ₂ O")	Thread Size
PV3	VFC300	42	1 1/2" MPT
PV4	VFC400	46	1 1/2" MPT
PV5	VFC504/500	68	1 1/2" MPT
PV6	VFC600	100	2" MPT
PV7	VFC704	98	2" MPT
PV8	VFC804	127	2" MPT
PV9	VFC904	127	2 1/2" MPT

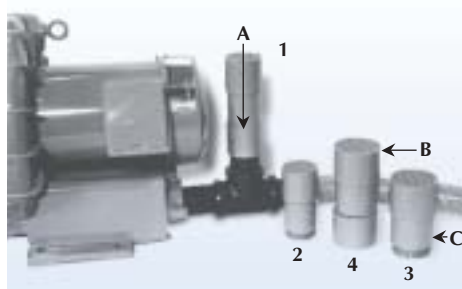
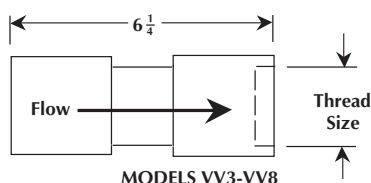
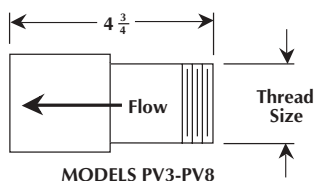

(A) Vacuum flow; (B) Vacuum relief valve; (C) Pressure relief valve; (1) VV5; (2) PV4; (3) PV6; (4) VV8 & VV9

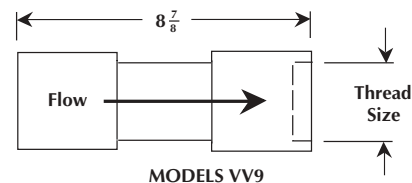
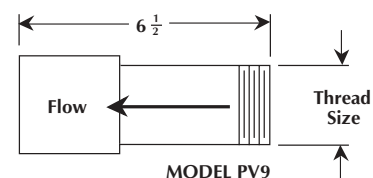

ACCESSORIES

VACUUM BOOSTER

The Vacuum Booster allows utilization of the Fuji Ring Compressor in a no-flow, or "dead-head" condition, when used in material handling, vacuum pick-up, and other industrial hold-down applications. The booster permits the necessary flow of cooling air through the blower and also boosts the critical "dead-head" operating pressure level by 10 to 15%. Please specify blower model.

Contact the Fuji applications engineering department for assistance in sizing.



(A) Cooling air flow; (B) Main suction line (may be dead-headed)

VACUUM BOOSTER	
Model No.	FOR USE WITH BLOWER MODEL:
VB45	VFC400-VFC504/500
VB67	VFC600-VFC704

ASPIRATORS

Some applications require conveying of a product where it is to be transported to a remote point. The use of an aspirator permits lightweight product to be conveyed by vacuum and then blown to a remote point without risk of any product getting to the blower.

The aspirator is ideal for applications such a transporting lightweight materials like paper trim, textile trim, film, dust, etc.



(X) Motive air; (Y) Product pick-up with vacuum flow; (Z) Air exhaust from "X" and material from "Y"

ASPIRATORS						
Model No.	A Dim. (Hose*)	A Dim. (Pipe*)	B Dim. (Hose/Pipe*)	C Dim. (Hose/Pipe*)	D Dim.** (in.)	E Dim.** (in.)
CA100	1 1/4"	1"	1 1/2"	1 1/2"	11"	4"
CA125	1 1/2"	1 1/4"	2"	1 1/2"	14"	5 1/2"
CA150	2"	1 1/2"	2 1/2"	1 1/2"	16"	6"
CA200	2 1/2"	2"	3"	1 1/2", 2"	19"	6"
CA250	2 1/2"	2 1/2"	3", 4"	2", 2 1/2"	24"	8"
CA300	3 1/2"	3"	4"	2 1/2", 3"	27"	9"

* Hose or Pipe (Specify)

** Dimensions D and E are approximate

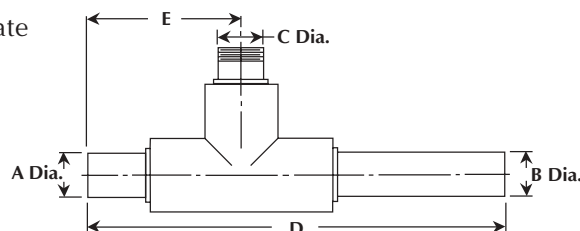

ACCESSORIES

BLOWER / ASPIRATOR COMBINATIONS

Aspirator Inlet Pressure -vs- Discharge Flow

(Tested with 30 ft. hose)

